

# SN-IPD54/14VDN(III)

# 1080P Indoor Network Dome



### Key features

- 1/2.9" Progressive Scan CMOS
- VF Lens 2.8-12mm
- Full HD 1080P
- Multiple Streams
- Low bitrate ,Good low light performance
- 3D DNR, dWDR, ICR

### Dimension

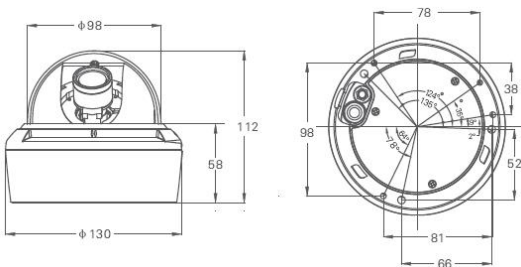

### Accessories

N/A

### Specifications

CAMERA	
Image Sensor	1/2.9" Progressive Scan CMOS
Min. illumination	Color 0.05Lux(AGC ON);B&W 0.01Lux(AGC ON)
Day & Night	ICR
Shutter Speed	1/5-1/20000
Auto Iris	Default Fixed, Auto Iris Optional
Wide Dynamic Range	dWDR
Digital Noise Reduction	2D/3D
Lens	2.8-12mm Lens
FOV	89° ~ 35°
IR LED	N/A
IR Range	N/A
IMAGE	
Video Compression	H.264 High/Main/Baseline Profile, MJPEG
Bit Rate (CBR/VBR)	Main stream:500kb-12000kb ;Sub stream 100kb-6000kb
Audio Compression	G.711 ,RAW_PCM
Max. Resolution	1920x1080/30fps
Stream	Stream1 1920x1080/1280x720 Stream 2 D1 to QVGA
Image Setting	Rotate Mode, Saturation, Brightness, Contrast, Sharpness
HLC	Yes
ROI	Yes
Defog	Yes
NETWORK	
Network Protocols:	HTTP,HTTPS, TCP/IP, UDP/IP, RTSP, DHCP, NTP, PPoE, Unicast and Multicast supported.
Alarm Trigger	Motion Detection, Network Disconnect, Disk alarm, I/O alarm
RTSP Video	Standard RFC2326, Support QuickTime / VLC Player.
Security	User security authentication, Reset, Hardware WatchDog
Web Language	English, Chinese, Polish, Italian, Portuguese, Spanish.(Sunell Brand)
System Compatibility	Onvif CGI
Interface	
Ethernet	1 Ethernet (10/100 Base-T) RJ-45 Connector
Audio I/O	Default Not support, optional 1ch Audio In,1ch Audio Out
Alarm I/O	Default Not support, optional 1ch Alarm In,1ch Alarm Out
RS485	N/A
BNC Output	Yes
Reset Button	Yes
Edge Storage	Micro SD/SDHC slot ,Max 32GB
GENERAL	
Power Supply	DC12V/POE
Power Consumption	5W(MAX)
Operating Temperature	-25℃~+55℃
Operating Humidity	0% - 90% RH
Ingress Protection	N/A
Approvals	CE / FCC
Product Dimensions	φ 130x112mm
Product Weight	400g